

# ***New All Cast Iron TEFC Motors from Emerson***

e|LINE™



eLine 11.1.02

  
**EMERSON**™  
Motor Technologies

# e|LINE™ *Product Overview*

- 1 – 30 HP TEFC Product
- Emerson Brand
- All Performance Data to be Located @ [www.elinemotors.com](http://www.elinemotors.com)
- Warranty 12 months
  - Throw away policy
  - No warranty repairs
- Order on Motorboss



# e|LINE™ from Emerson - A new 1-30 HP TEFC Product Offering

## Features Include...

- Cast Iron Frame,
- Cast Iron Conduit Box
- Cast Iron Fan Cover Guard
- 3600, 1800, 1200 RPM
- Energy Efficient - CC050A
- Continuous Duty
- Same Size Double Shielded Bearings on Drive and Non-Drive End
- IP55 Protection
- 208-230/460 Volts on 60 Hz (575 Volts Available)
- 380 Volts on 50 Hz
- 60 and 50 Hertz Operation Without De-Rating HP
- Double Drilled Holes in Feet
- VPI, Class F Insulation System, B rise at Full Load
- Stainless Steel Nameplate
- Zinc Coated Hardware

## e|LINE™ *Features Continued*

- Inverter Grade Insulation System
- Meets NEMA MG-1 Part 31 Specification
- Speed Range – 10:1 VT and 5:1 CT
- Ambient Temperature –15 to 40° C
- Suitable for wye-delta start on 210T Frame and larger
- Nema Design B Performance
- Lifting Provisions
- Field Convertible to F2 Mounting
- Shaft Seal V-ring
- Service Factor's from 1.15 to 1.40
- Available in Footed or C-face Footed from Stock
- Field Convertible C-face Kits
- CE Mark on Nameplate
- CSA 390 Certified
- UL Recognized

# e|LINE™ Nameplate

RNG-49-48	Hz	60	50	CATALOG	eLT25E2D			
	HP	25	18.65 kW	MODEL	EL28			
	RPM	1760	1445	TYPE	ELT	FRAME	284T	
	V	208-230/460	380	PH	3	INS.CL.	F	
	A	61.7-56.0/28.0	35.0	WT	386	Lbs	ENCL	TE-IP55
	max KVAR	9.2	10.0	DUTY:	CONTINUOUS		ID	F09C
	SF	1.15	1.0	DE/ODE BRG	6311 2Z C3			
	SFA	31.7	35.0	CC	LR 40599			
	nom PF	91.0	90.0	SP <sup>®</sup> <sub>US</sub>	CSA <sup>®</sup> <sub>E</sub>			
	nom EFF	92.4	89.9	www.e-LineMotors.com				
gar EFF	91.4	88.6	 <b>e LINE™</b> Reg. U.S. Pat. & TM. Off <b>EMERSON™</b> FABRIQUE EN MADE IN POLAND POLOGNE					
DESIGN	B	B						
CODE	F	D						

60Hz & 50Hz Data

# e|LINE™ Packaging

			
MADE IN POLAND			
HP 1,5	RPM 3600	HZ 60	PH 3
VOLTS 208-230/460		WT 57,7 lbs	
FR 143T		TYPE ELT	
SER NO F10C			
SHIP TO	Emerson Venezuela. Phone # 58-212-2377522, 58-212-237-7356. Caracas - Venezuela		
MODEL NO	<b>ELO3</b>	MFG DATE	
			<b>OCT02</b>
CAT NO	<b>eLT32E1D</b>		
			

eLine 11.1.02

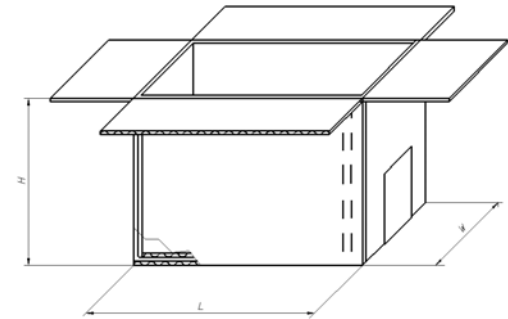

140 Frame

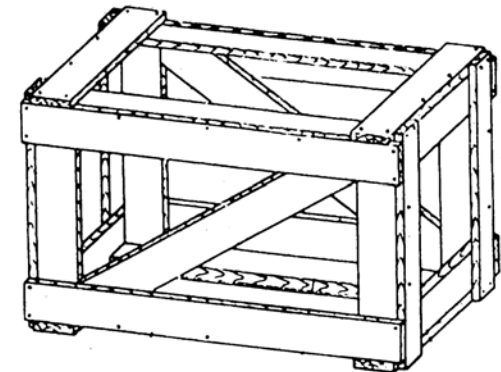

180-280 Frames

# www.elinemotor.com

**GENERAL PURPOSE  
THREE PHASE, TEFC SEVERE DUTY  
ENERGY EFFICIENT - ALL CAST IRON**



**APPLICATIONS :**

Designed for severe duty environments found in the pulp & paper, lumber, aggregates, mining, chemical and other industries.

**FEATURES:**

- \* Fully comply with EPACT 92 and NRCan efficiency standards
- \* Inverter Grade insulation to meet NEMA MG-1 Part 31 Specification
- \* 10:1 variable torque; 5:1 constant torque on inverter power
- \* 40°C ambient, continuous duty
- \* Double shielded bearings of same size on both ends
- \* Double drilled feet to accommodate mounting flexibility
- \* VPI, Class F insulation system, B rise at full load on sine wave power
- \* Nema design B performance
- \* Shaft seal V-ring for IP55 protection
- \* Lifting provisions
- \* Field convertible to F-2 mounting
- \* Suitable for wye-delta start on 210T frame and larger
- \* Corrosion resistant mill & chemical duty paint
- \* Stainless steel nameplate and zinc plated hardware
- \* Dual Voltage nameplated @ 60Hz and 50 Hz
- \* Full 50 Hz power at rated HP
- \* DOE Compliance Certification .
- \* CE mark on nameplate
- \* CSA 390 Certified
- \* Field convertible C flange kits available

HP	RPM	Frame	Volts	Catalog	Model	Type	List	DS		Full Load		Ship	Notes
				#	#			SYM	SF	EFF	PF	WGT	
1	1800	143T	208-230/460	ELT1E2D	EL01	ELT	\$180	3ELT	1.40	82.5	75.0	62	C
	1200	145T	208-230/460	ELT1E3D	EL02	ELT	\$240	3ELT	1.40	80.0	73.0	63	
1.5	3600	143T	208-230/460	ELT3E1D	EL03	ELT	\$220	3ELT	1.30	82.5	87.0	62	
1.5	1800	145T	208-230/460	ELT3E2D	EL04	ELT	\$225	3ELT	1.40	84.0	79.0	65	
	1200	182T	208-230/460	ELT3E3D	EL05	ELT	\$265	3ELT	1.40	85.5	72.0	111	C
2	3600	145T	208-230/460	ELT2E1D	EL06	ELT	\$245	3ELT	1.40	84.0	87.0	68	
	1800	145T	208-230/460	ELT2E2D	EL07	ELT	\$230	3ELT	1.40	84.0	82.0	67	

[www.elinemotor.com](http://www.elinemotor.com)

**eLINE Mounting and overall dimensions**  
Foot-mounted NEMA-Frames

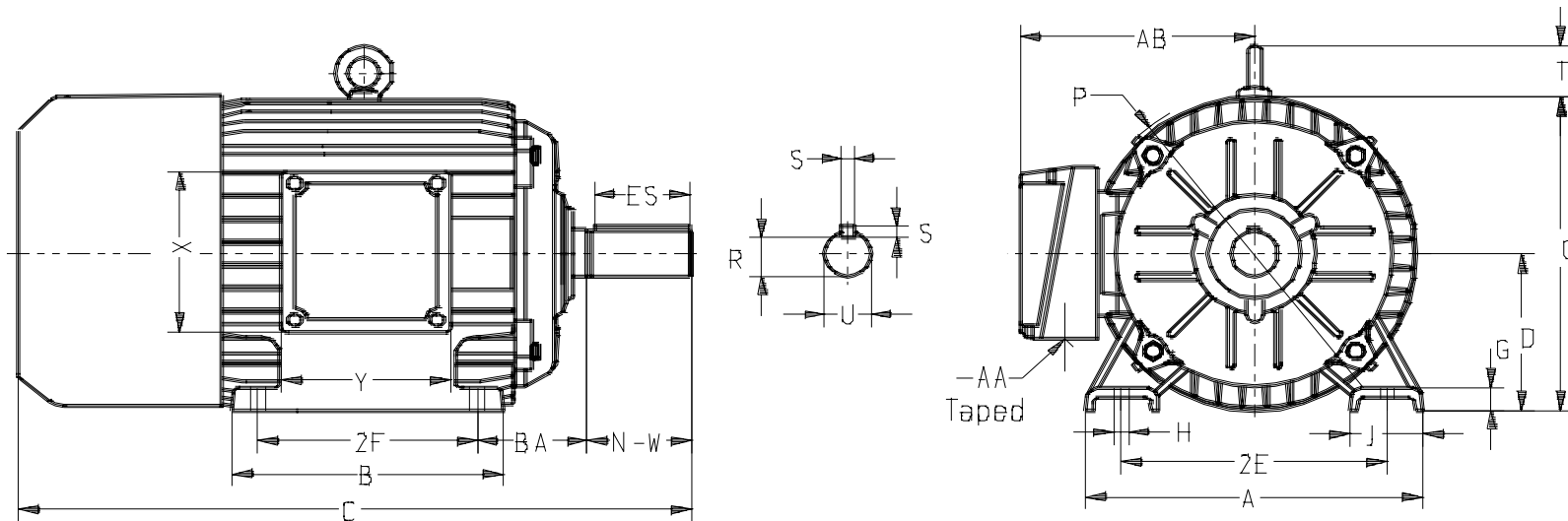

Frame	Mounting dimensions (inches)												
	A	B	D	2E	2F	H	R	S	U	N-W	AA	BA	ES
143T	6.62	5.83	3.50	5.50	4.00	0.34	0.771	0.188	0.875	2.25	0.75	2.75	1.52
145T	6.62	7.00	3.50	5.50	5.00	0.34	0.771	0.188	0.875	2.25	0.75	2.75	1.52
182T	9.00	6.74	4.50	7.50	4.51	0.41	0.986	0.250	1.125	2.75	1.00	3.50	1.94
184T	9.00	8.31	4.50	7.50	5.51	0.41	0.986	0.250	1.125	2.75	1.00	3.50	1.94
213T	10.24	8.10	5.25	8.50	5.50	0.41	1.201	0.312	1.375	3.38	1.00	4.25	2.55
215T	10.24	9.60	5.25	8.50	7.00	0.41	1.201	0.312	1.375	3.38	1.00	4.25	2.55
254T	12.28	9.92	6.25	10.00	8.25	0.55	1.416	0.375	1.625	4.00	1.25	4.75	3.11

THREE PHASE, TEFC SEVERE DUTY  
ENERGY EFFICIENT - ALL CAST IRON



## eLINE Typical Performances

HP	NEMA Frame size	RPM		TORQUE [%]		AMPS													
						60 HZ												50HZ	
						208v			230v			460 v			575v			380V	460V
						Syn.	Full Load	Locked Rotor	Break down	Full Load	Locked Rotor	@ SF	Full Load	Locked Rotor	@ SF	Full Load	Locked Rotor	@ SF	Full Load
1	143T	1800	1755	295	310	3,1	21.7	4.2	3.0	24	3.8	1,5	12,0	1.9	1,2	9,6	1.5	1.8	1.7
1	145T	1200	1155	180	290	3,3	14.7	4.4	3.2	16.2	4.0	1,6	8,1	2.0	1,3	6,5	1.6	2.0	1.7
1.5	143T	3600	3500	275	320	4,2	29.7	6.0	4.0	32.8	5.4	2,0	16,4	2.7	1,6	13,1	2.2	2.4	2.1
1.5	145T	1800	1745	265	370	4,6	28.8	6.0	4.2	31.8	5.4	2,1	15,9	2.7	1,7	12,7	2.2	2.6	2.3
1.5	182T	1200	1175	255	350	5,2	29.7	6.4	4.6	32.8	5.8	2,3	16,4	2.9	1,8	13,1	2.3	2.7	2.6
2	145T	3600	3505	280	325	5,3	40.2	7.5	5.2	44.4	6.8	2,6	22,2	3.4	2,0	17,8	2.7	3.2	2.7
2	145T	1800	1735	240	330	5,8	33.3	8.0	5.4	36.8	7.2	2,7	18,4	3.6	2,2	14,7	2.9	3.3	2.9
2	184T	1200	1165	210	270	6,4	31.8	8.2	5.8	35.2	7.4	2,9	17,6	3.7	2,3	14,1	3.0	3.5	3.1
3	182T	3600	3510	220	280	8,9	49.9	10.6	7.6	55.2	9.6	3,8	27,6	4.8	3,1	22,1	3.8	4.7	4.1
3	182T	1800	1745	260	380	8,8	55.7	10.4	7.8	61.6	9.4	3,9	30,8	4.7	3,1	24,6	3.8	4.7	4.3
3	213T	1200	1170	230	350	9,3	56.1	11.5	8.4	62	10.4	4,2	31,0	5.2	3,4	24,8	4.2	5.0	4.6
5	184T	3600	3500	225	280	13,4	79.6	18.1	12.4	88	16.4	6,2	44,0	8.2	4,9	35,2	6.6	7.7	7.0
5	184T	1800	1735	250	320	13,8	81.4	17.7	12.4	90	16.0	6,2	45,0	8.0	5,0	36,0	6.4	7.6	6.6
5	215T	1200	1155	190	250	14,4	72.3	18.6	13.2	80	16.8	6,6	40,0	8.4	5,2	32,0	6.7	8.1	6.9
7.5	213T	3600	3500	220	350	18,6	101.3	25.4	17.2	112	23.0	8,6	56,0	11.5	6,9	44,8	9.2	11.2	8.6
7.5	213T	1800	1750	200	280	19,8	111.8	25.9	18.0	123.6	23.4	9,0	61,8	11.7	7,2	49,4	9.4	11.3	9.3
7.5	254T	1200	1180	260	220	20,8	107.1	27.4	18.4	118.4	24.8	9,2	59,2	12.4	7,3	47,4	9.9	11.7	9.3